

INSTALLATION NOTES:

1. PREPARE MICROSTRIP BOARD AND HOUSING AS DESCRIBED BELOW.
2. INSTALL RELAY WITH RF PINS ALIGNED WITH MICROSTRIP TRACES. SECURELY FASTEN USING MOUNTING SCREWS AS SHOWN.



3. **CAUTION: APPLY ANY FORCE CREATED BY SOLDERING IRON "PERPENDICULAR" TO AXIS OF PINS TO AVOID POSSIBLE PIN MOVEMENT.**
  - SOLDER PINS TO TRACES USING Sn 63 SOLDER OR EQUIVALENT.
  - AVOID CONTAMINATION OF FLUX, CLEANING SOLUTIONS ETC. TO RELAY AS PERMANENT DAMAGE WILL RESULT. (BATCH CLEANING IS NOT RECOMMENDED FOR RELAY IS A NON-SEALED DEVICE).

RELAY DEVICE

MICROSTRIP BOARD (BOARD CUTOUT DETAIL)

HOUSING

2X #2-56 X 3/8 LONG PAN HEAD SCREW AND #2 LOCK WASHER

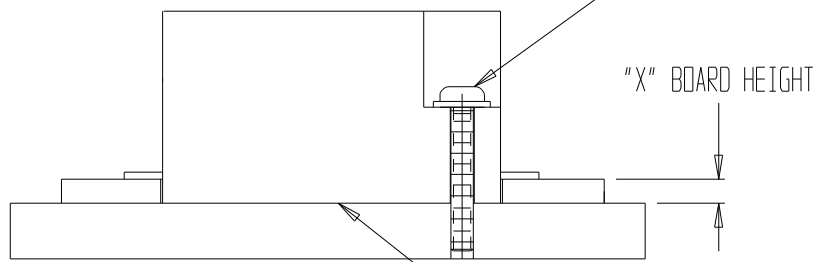

"D" HOUSING POCKET DEPTH  
NOT REQUIRED WITH .062 THICK MICROSTRIP PCB

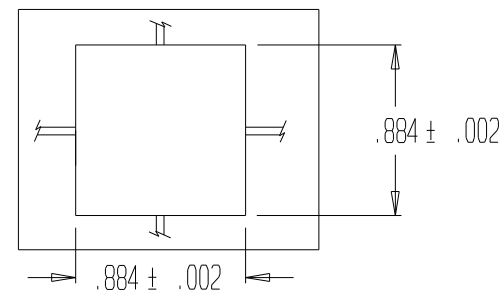

SCALE 1:1

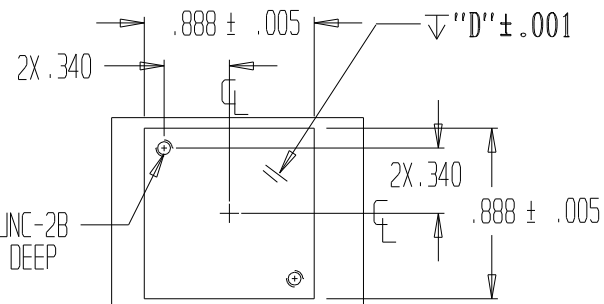

(HOUSING POCKET DETAIL)

SCALE 1:1 "D" = .062-X

REV	ECN NO.	DATE	APPROVAL

UNLESS OTHERWISE SPECIFIED:  
DIMENSIONS ARE IN INCHES  
AND INCLUDE PLATING.  
TOLERANCES  
.XX ± .01 ANGLES ± 5°  
.XXX ± .005 SURFACE QUALITY  
.XXXX ± .0020 63/ MAX

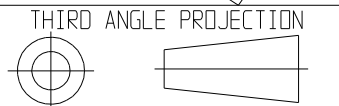

DR B. JONES 12/19/01  
CK M. MAGDA  
ENG B. JONES  
MFG  
QA  
THIS DRAWING AND SPECIFICATIONS ARE THE PROPERTY OF RELCOMM TECHNOLOGIES AND SHALL NOT BE REPRODUCED OR COPIED OR USED IN WHOLE OR IN PART AS THE BASIS FOR THE MANUFACTURE OR SALE OF ITEM(S) WITHOUT WRITTEN PERMISSION.

		<b>RELCOMM TECHNOLOGIES, INC.</b> 610 BEAM STREET SALISBURY, MARYLAND 21801	
TITLE RTT-SERIES RECOMMENDED MOUNTING DETAIL			
SIZE A	DWG NO. 15-026-02	REV -	
SCALE 2:1	DO NOT SCALE DWG	SHEET 1 OF 1	